



TRIAC constant voltage LED dimmable driver

Skydance TRIAC dimmable driver is compatible with (forward-phase or leading-edge), ELV (reverse-phase or trailing-edge) TRIAC dimmer and AC Push-Dim switch. It has the function both LED driver and LED controller. This series has both constant voltage and constant current to meet multiple demands.



Main Features

- Apply to leading edge/trailing edge Triac dimmers and dimming system.
- PWM digital dimming, no alter LED color rending index.
- 1 channel constant voltage output, Max. total output power 75W.
- Over-heat / Over-load / Short circuit protection, recover automatically.
- Full protective plastic case.
- Suitable for indoor LED lighting application.

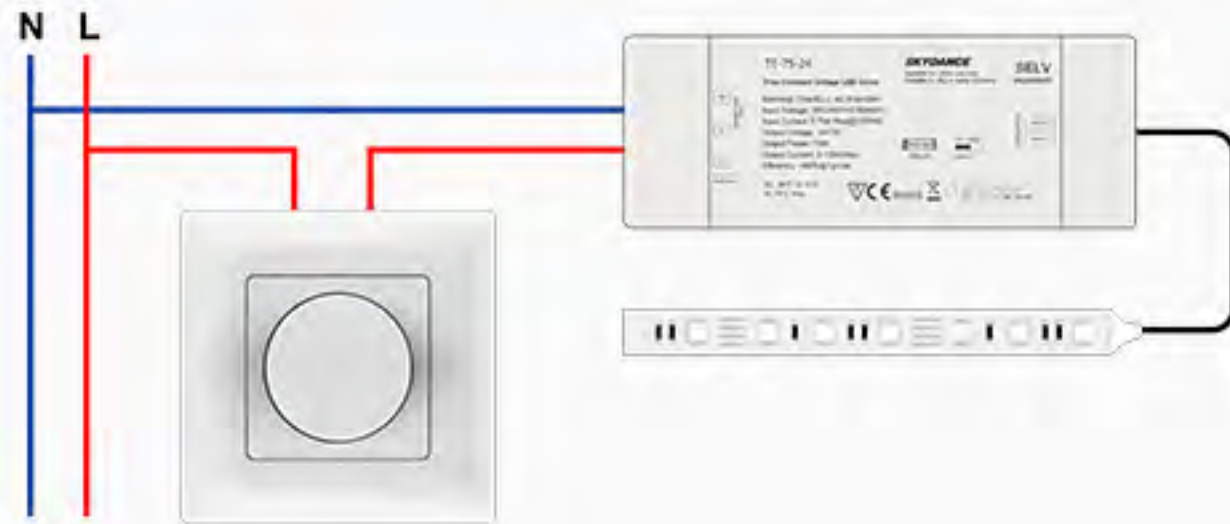

**Connect Triac dimmer
(no Neutral wire)**

Connect Triac dimmer (with Neutral wire)

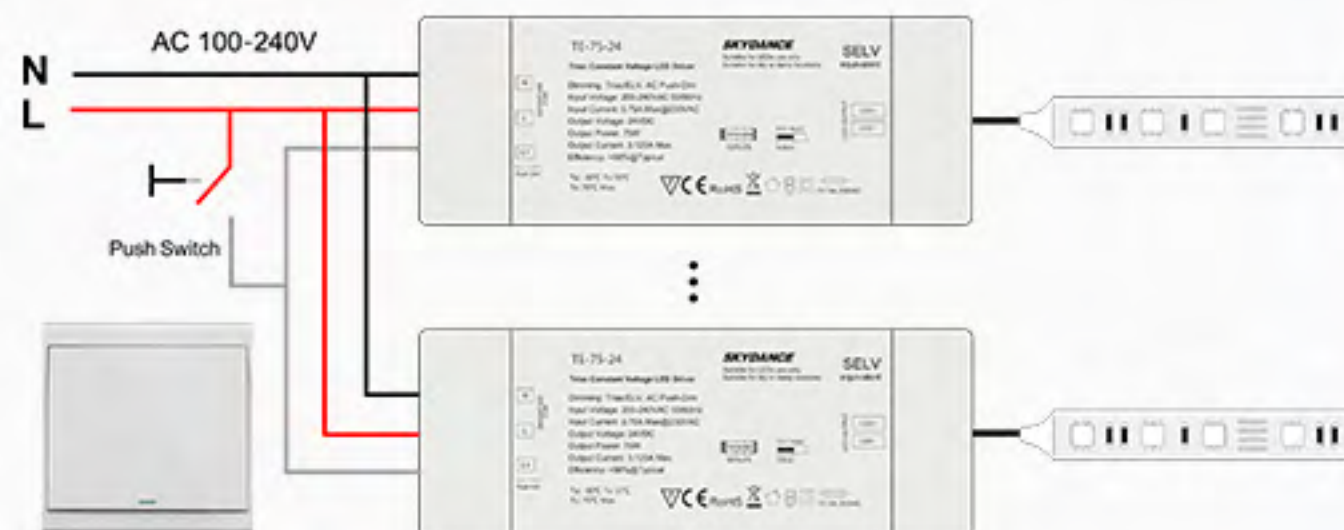
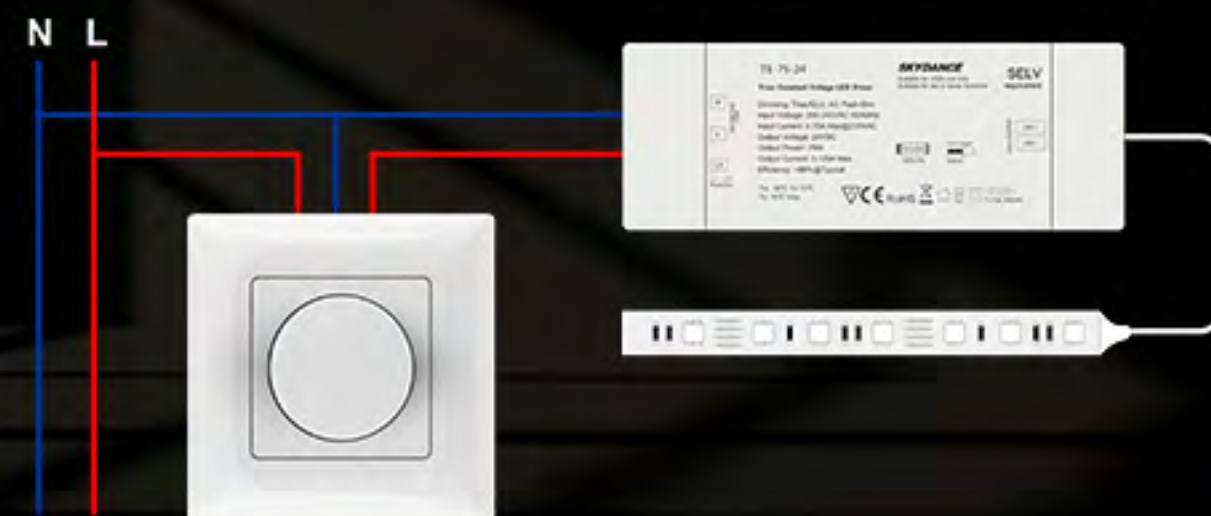

Connect AC Push switch



Short press

Turn on or off light.

Long press (1-6s)

Press and hold to step-less dimming,
With every other long press, the light level goes to the opposite direction.

With dimming memory

Full protection to make sure the safty during using.

Over Load Power

Short Circuit

Over Temperature



High-quality components support 50000hr liftspan.

